



Love2learnapple.com



Zoom In On iPad/iPhone
Here's To Your Health
Have an Improved Battery

Cyndi Feeney
August, 2020

What Do Ya Know? 🤔

What You Will Learn 🎓🎓

“It's Easy - I'll Show You How”

Health App on Your iPhone

Improved Battery for iPhone and iPad

Analyze Battery Usage

Determine How to Manage & Get Most of Battery Time

How to Refresh

Your Locations Affect Usage

Emergency to Conserve

Most of you have heard me urge you to complete the Health App (white app with red heart) on your iPhones. Some of you have forgotten or neglected to do this most important feature on your devices. Remember, that EMT do not need your pass code to get to this Vital and life saving info if you are not able to communicate.



How to set up your Medical ID

Open the Health app and tap the Summary tab.

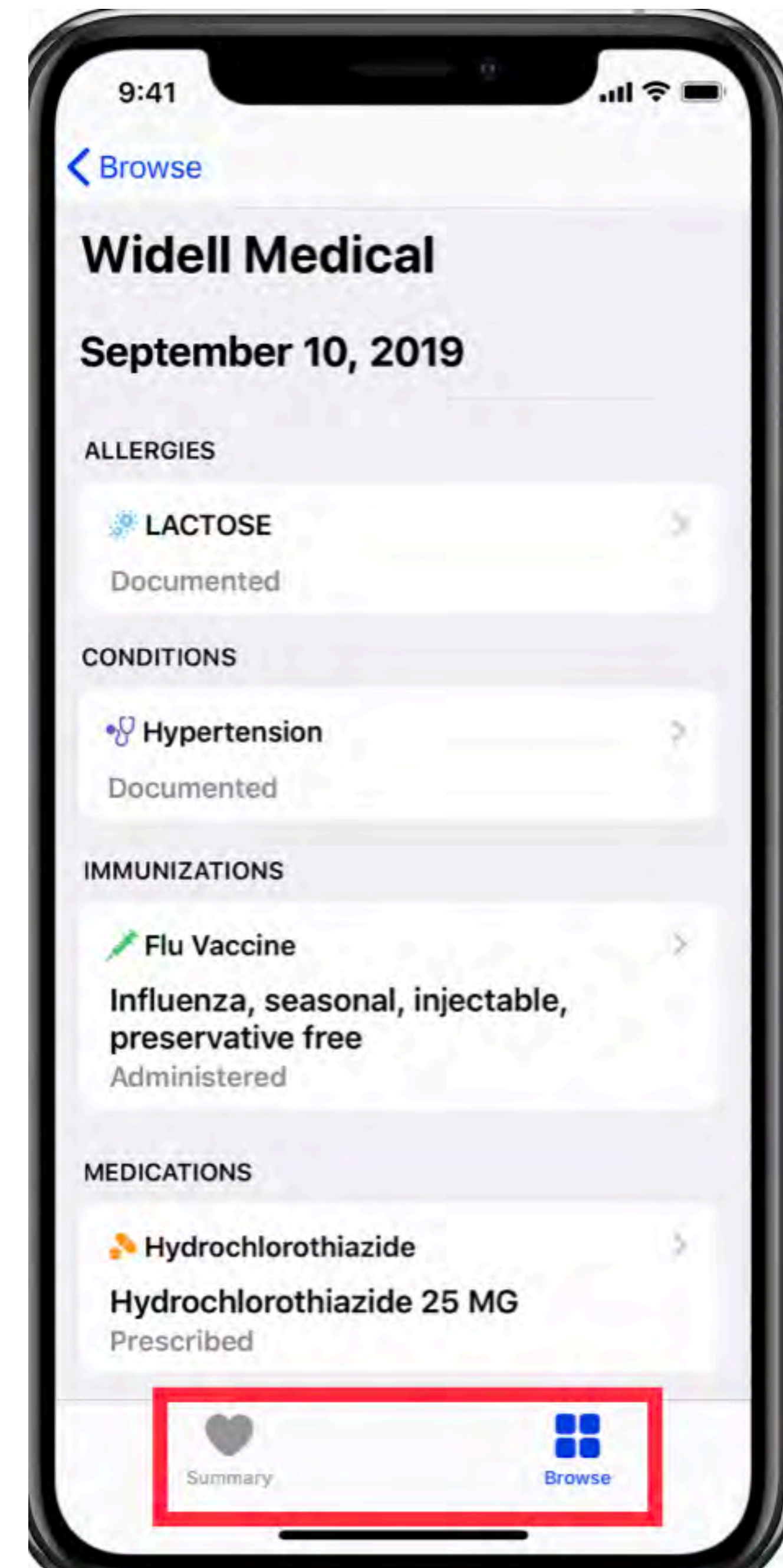

Tap your profile picture in the upper-right corner.

Under Medical Details, tap Medical ID.

Tap Edit in the upper-right corner.

To make your Medical ID available from the Lock screen on your iPhone, turn on Show When Locked.

In an emergency, this gives information to people who want to help.

To share your Medical ID with emergency responders, turn on Share During Emergency Call.

When you make a call or send a text to emergency services on your iPhone or Apple Watch, your Medical ID will automatically be shared with emergency services.*

Enter health information like your date of birth, allergies, and blood type.

Tap Done.

<https://support.apple.com/en-us/HT207021>

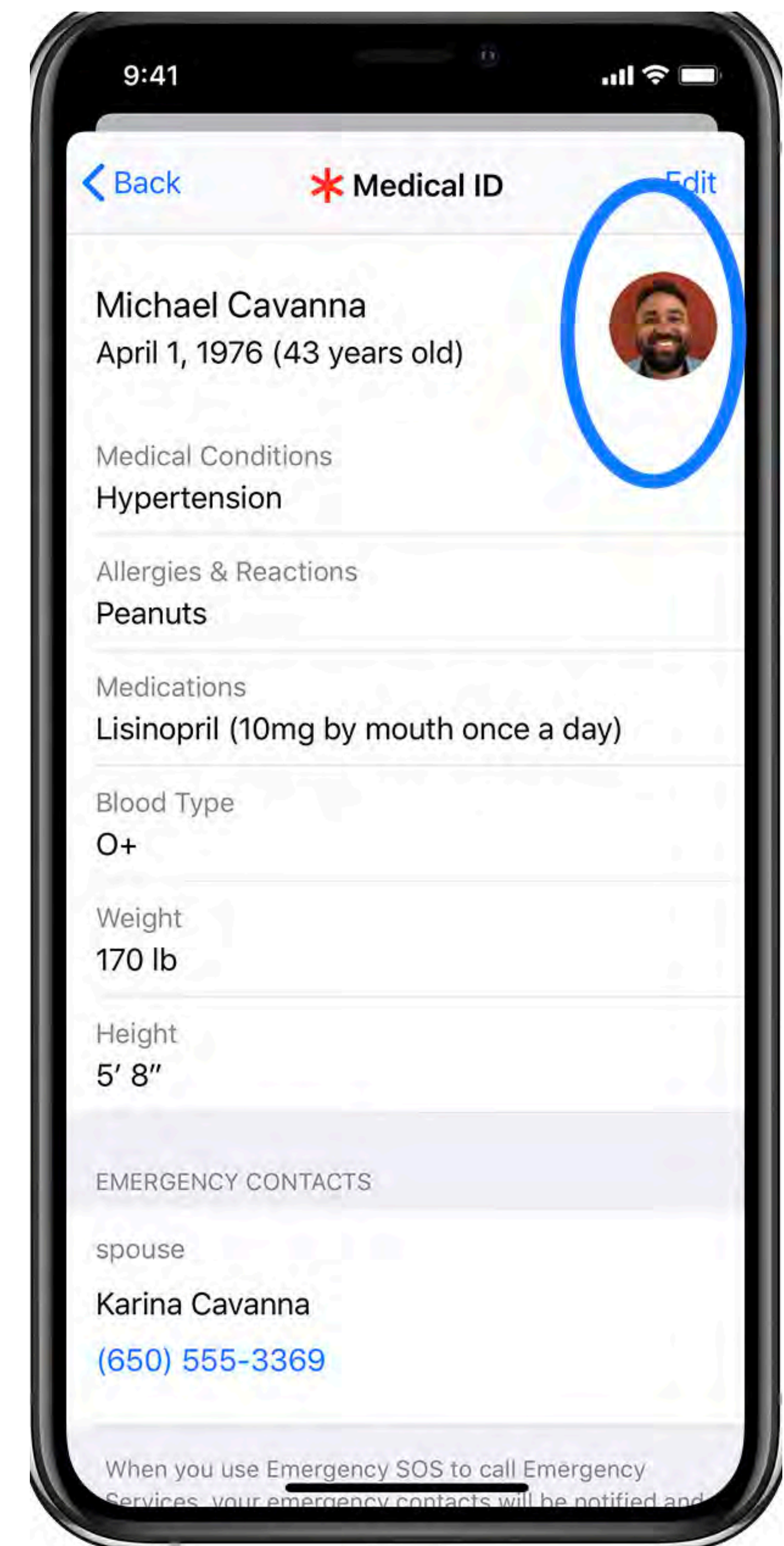

Settings App

It All Starts Here
Long Press on App
See Menu for More



Choose Battery

Let's Take a Look at
What you've been doing



AHAH!!!!

LOTSA ZOOMING & MAIL

Scroll Down to See More

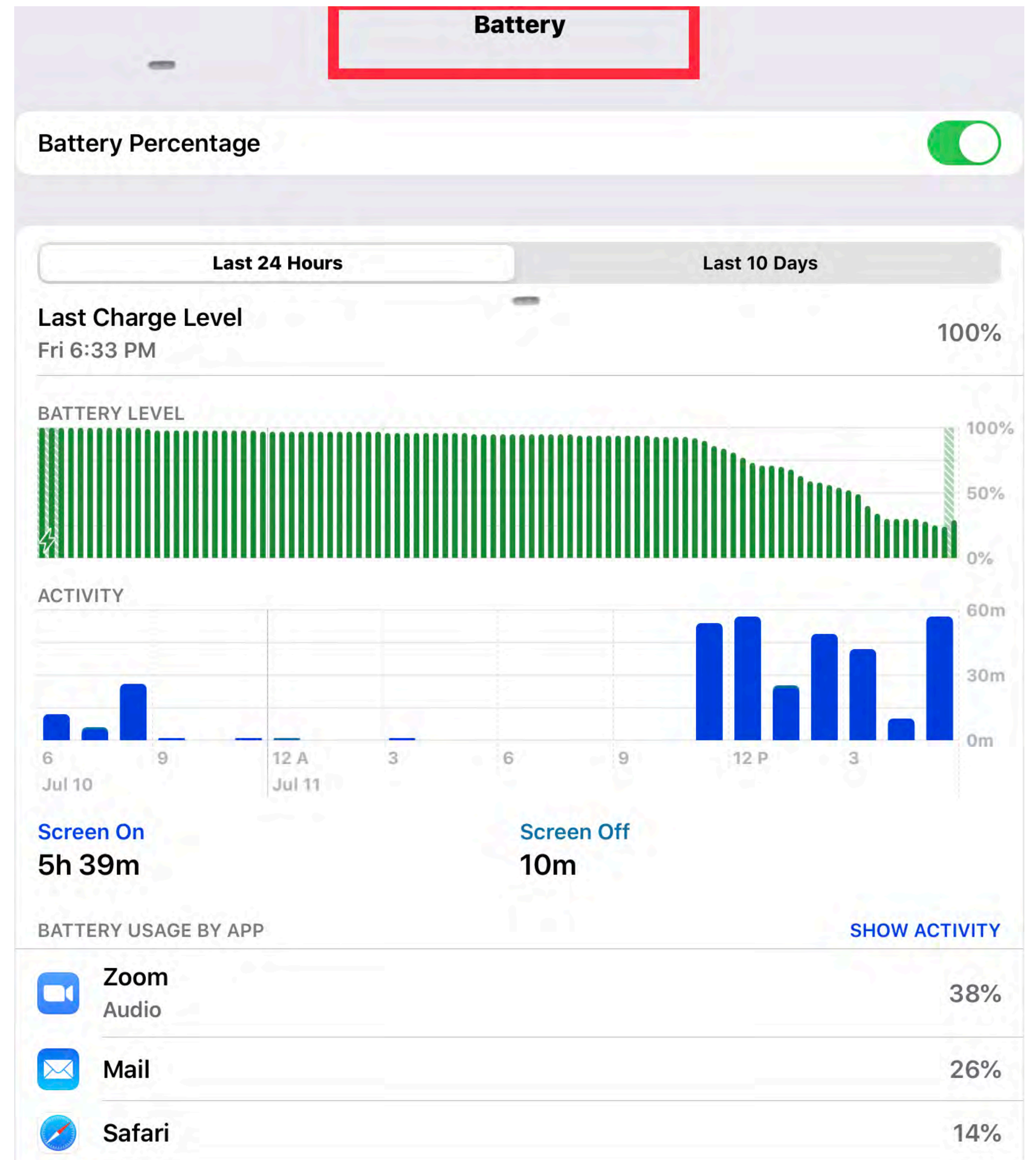

Let's Check Out What's doing in Accessibility

Choose Display & Text Size

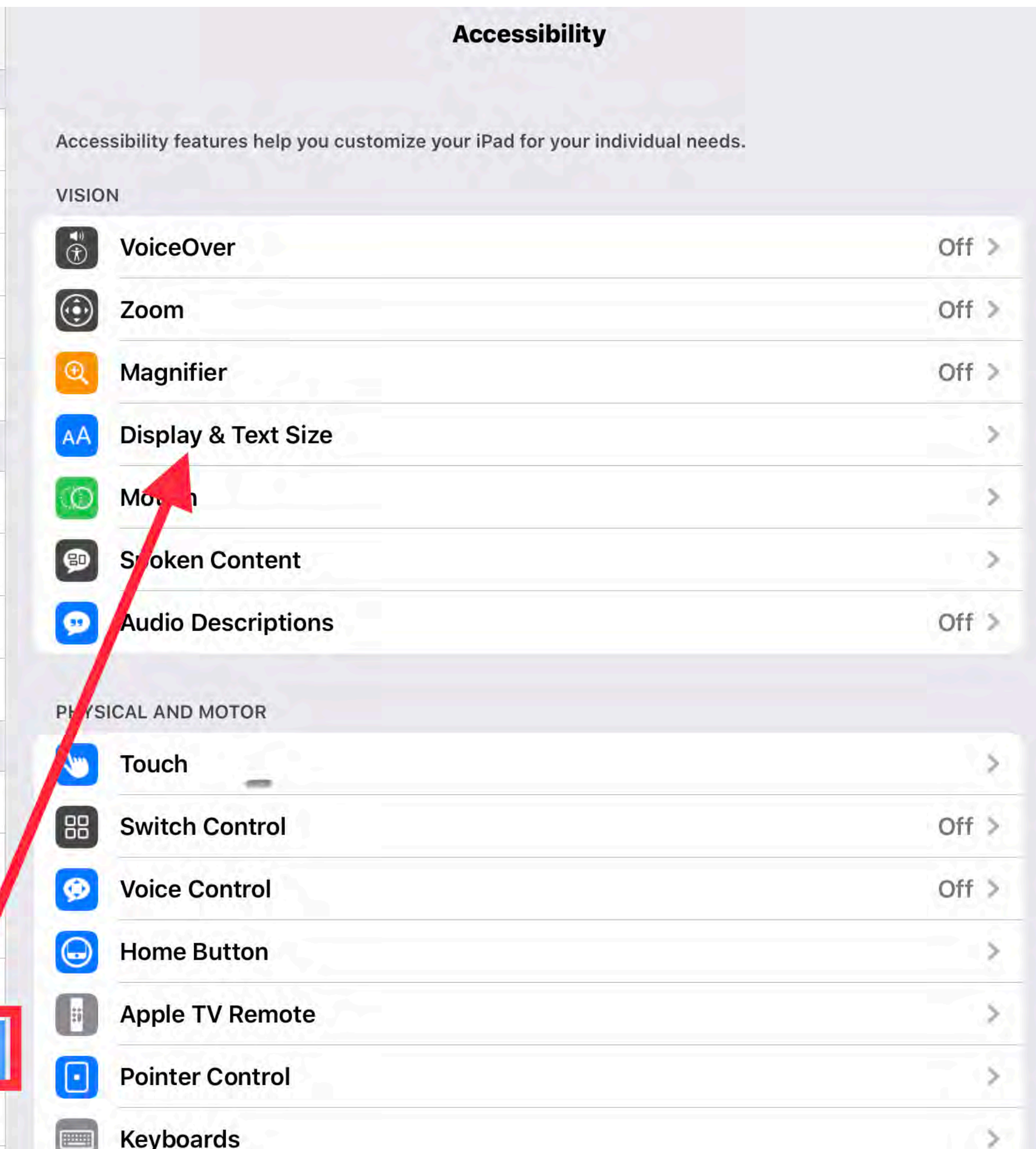
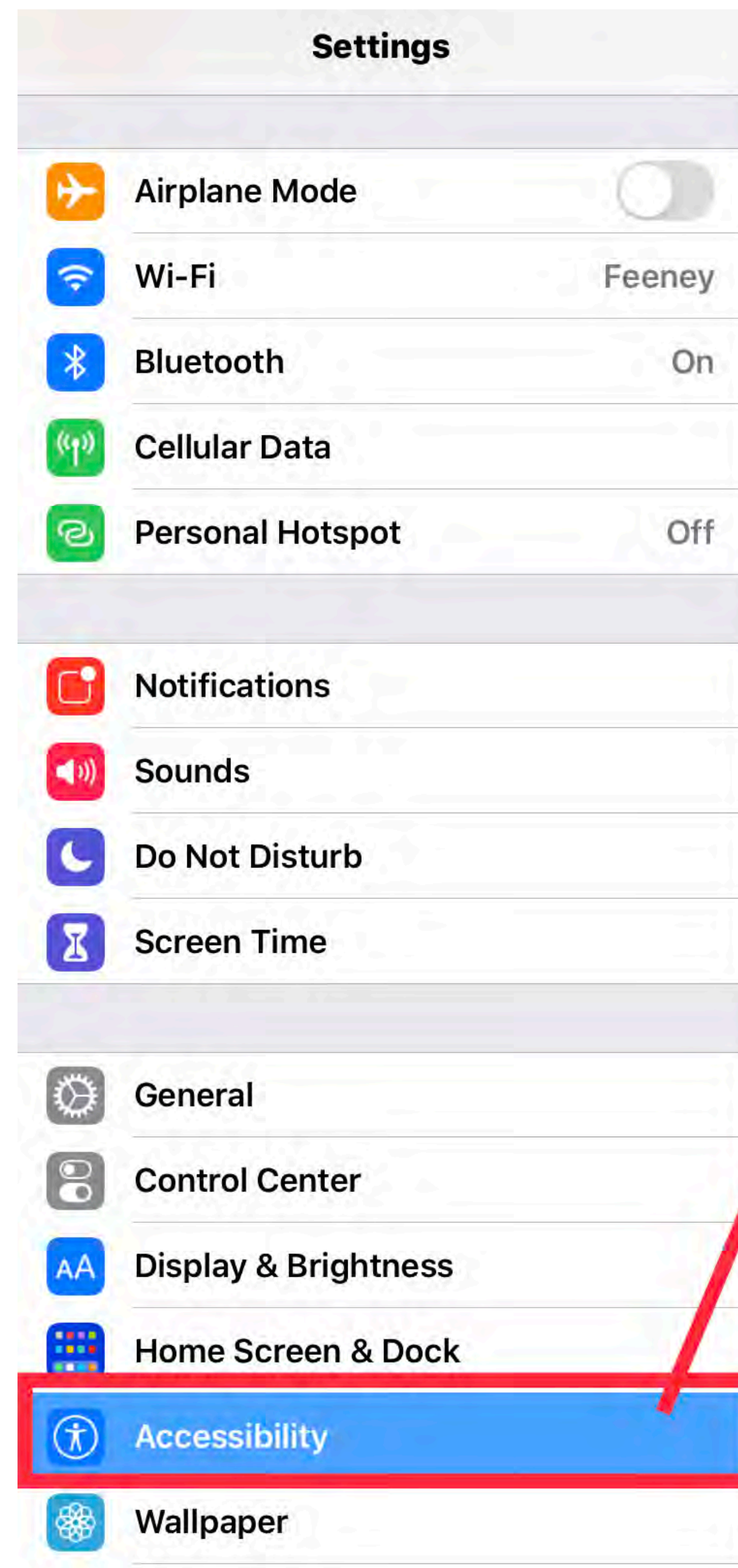

This is the top of the screen (Didn't all fit in my screenshot)

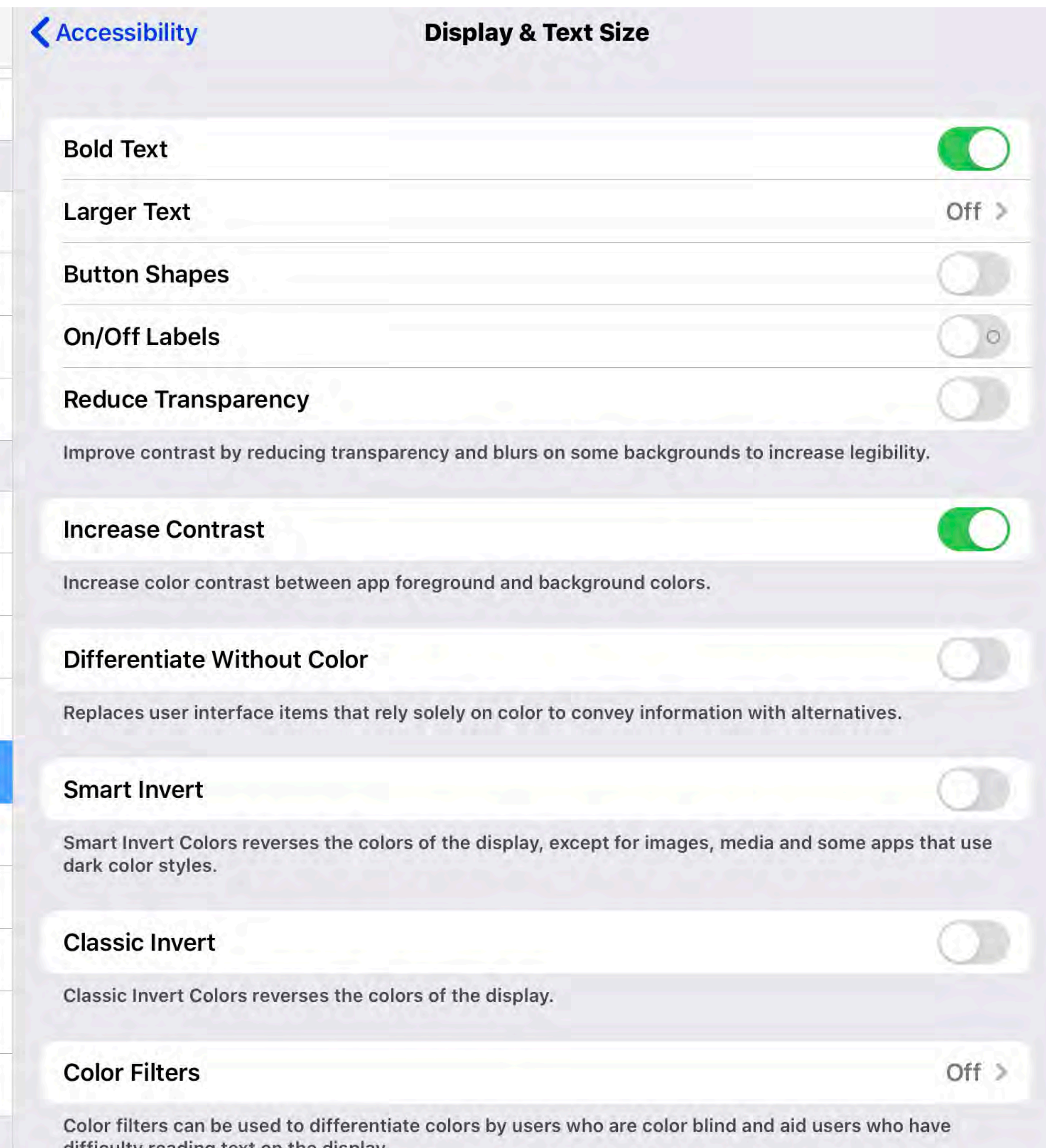
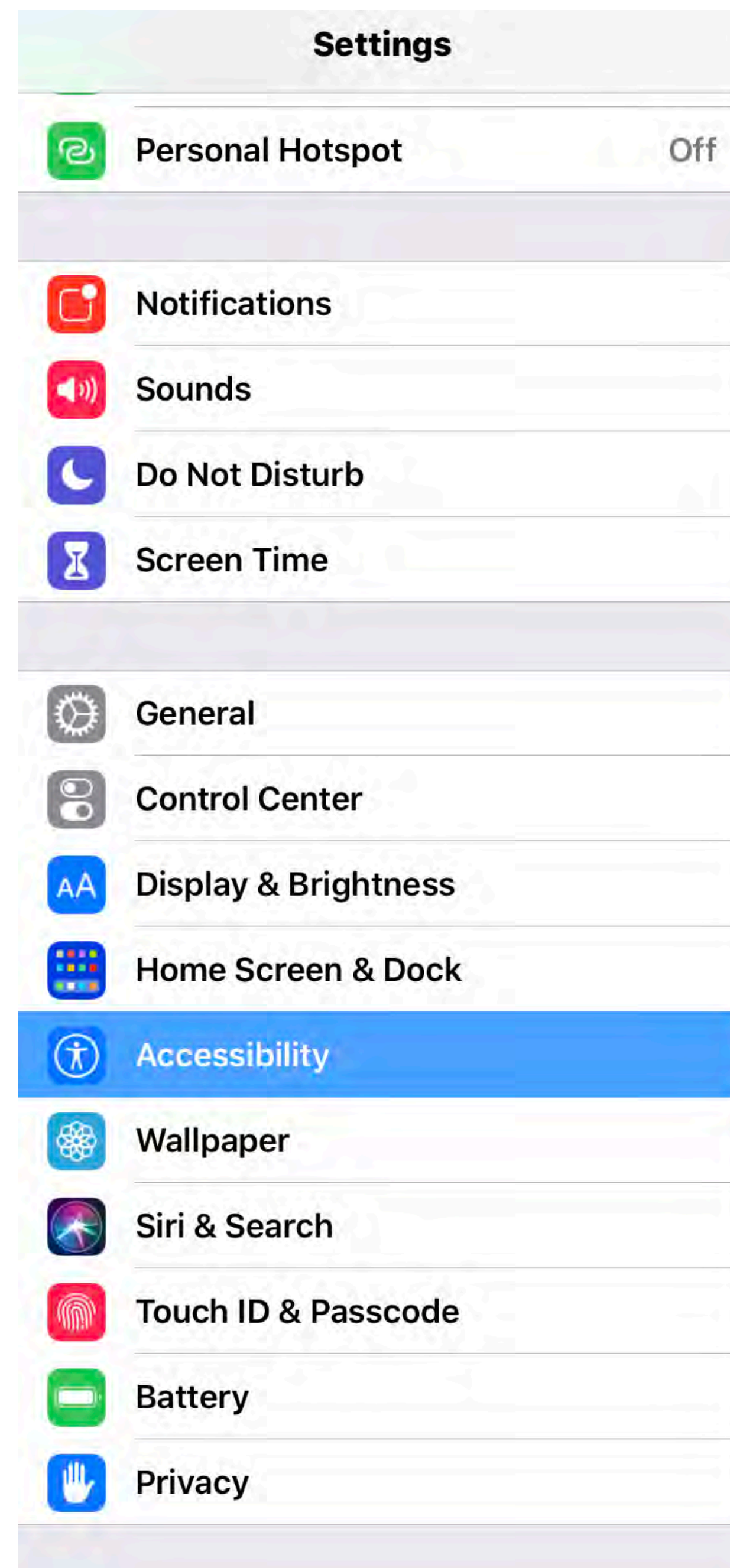

2nd Part of Screenshot

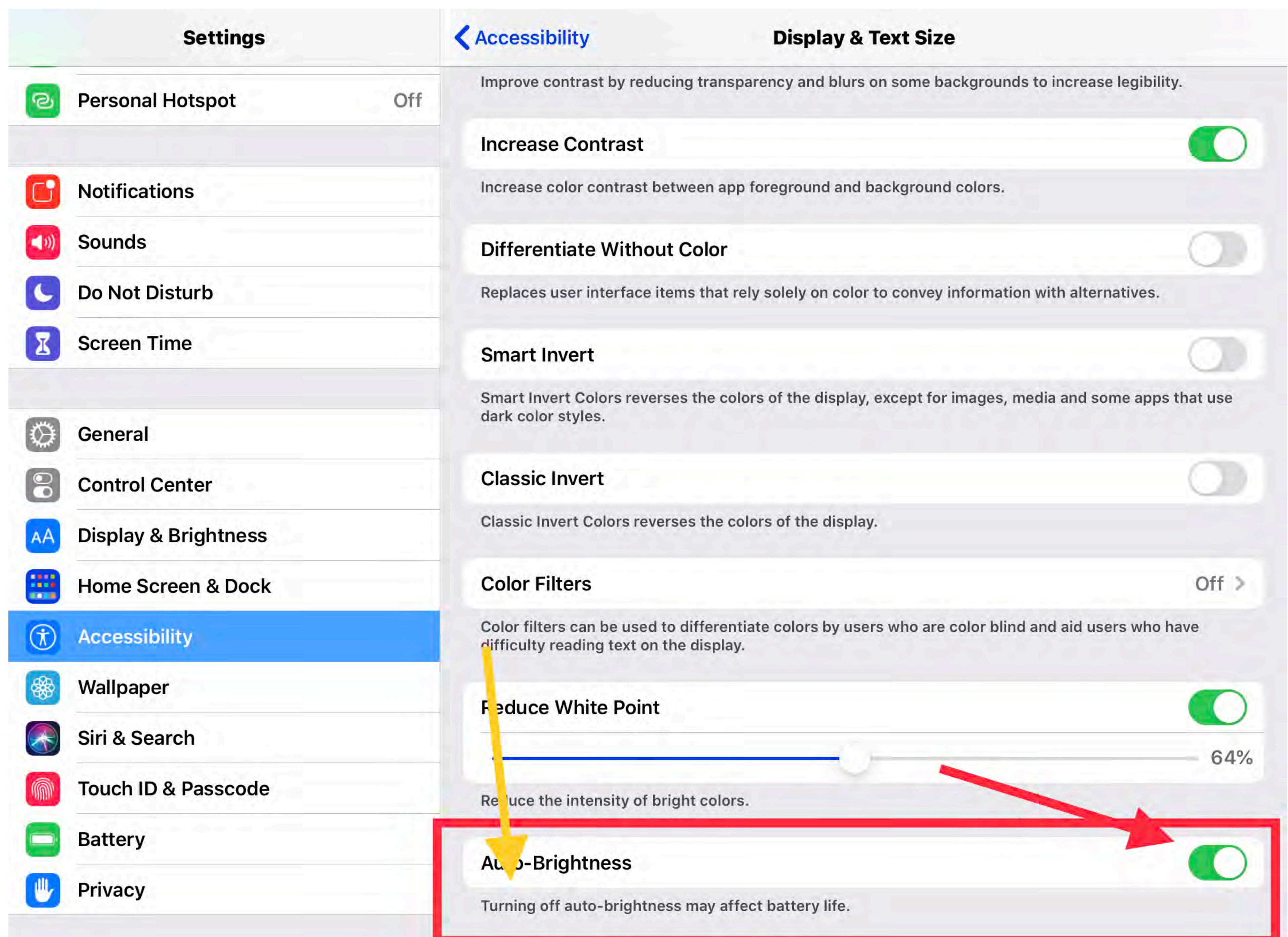

This time I typed **Refresh** to find it quickly

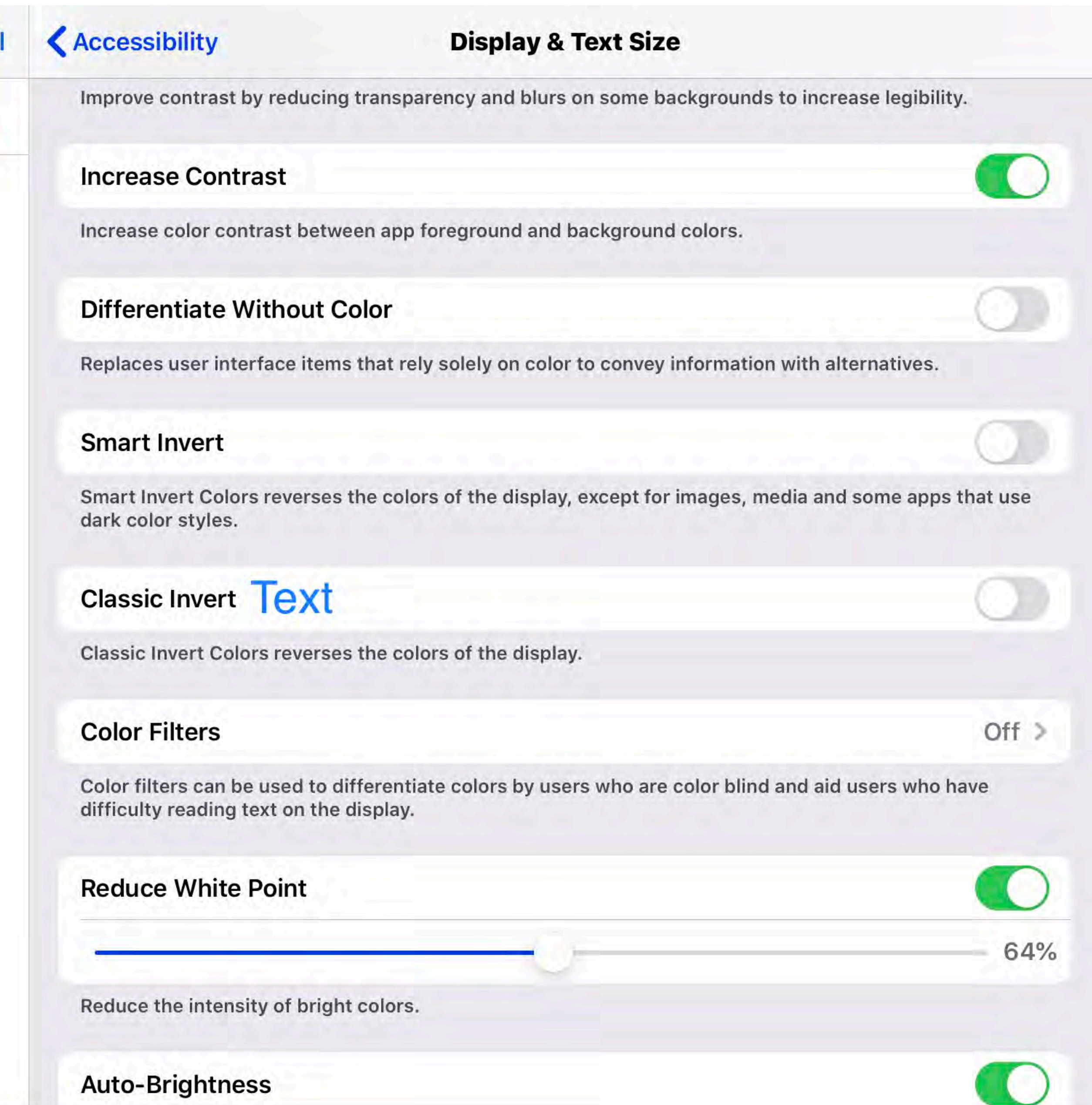

Here's where we
Make decisions
What is important to
Each of us

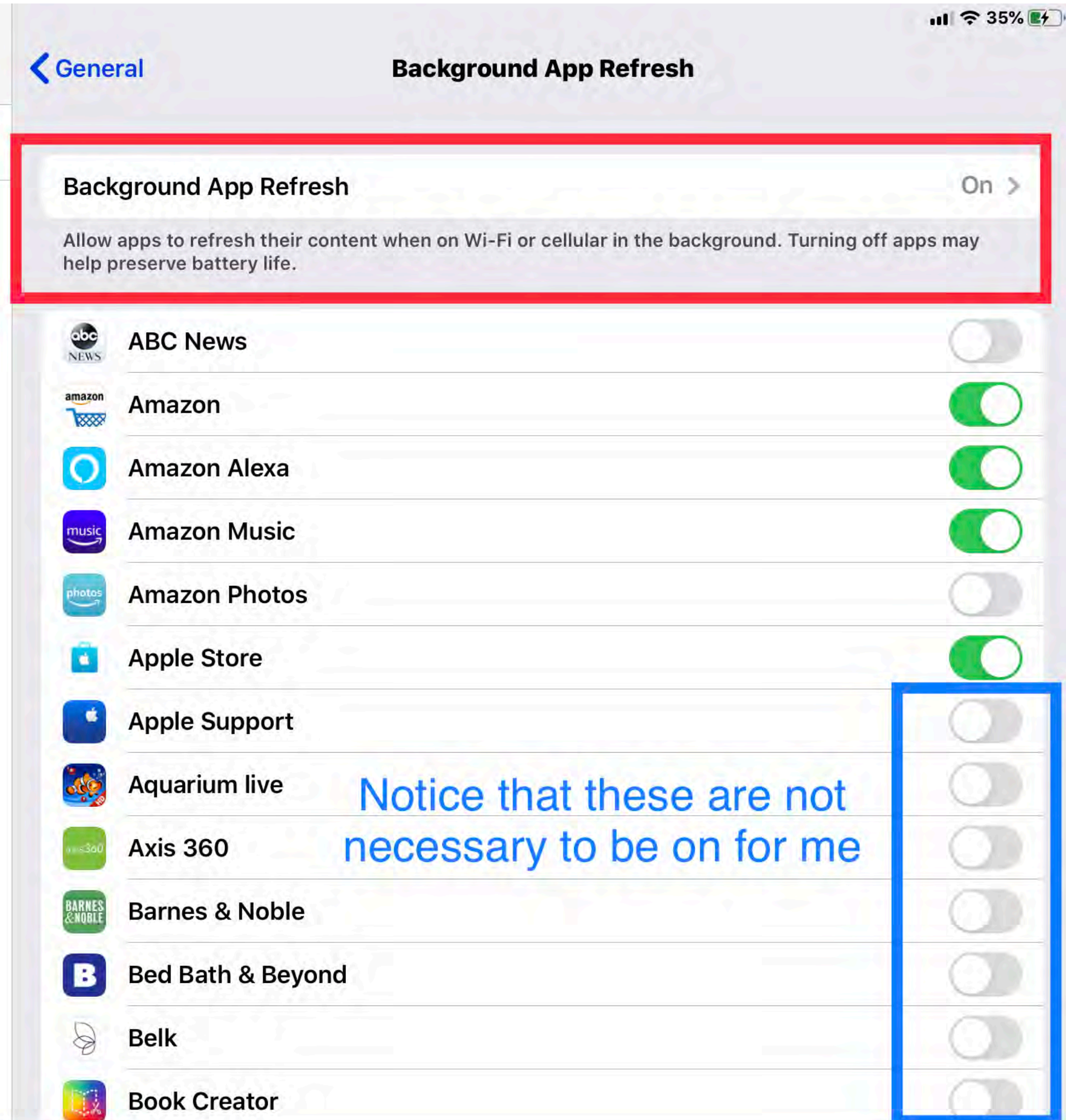

Locations

Choose What You Want/Need Mostly

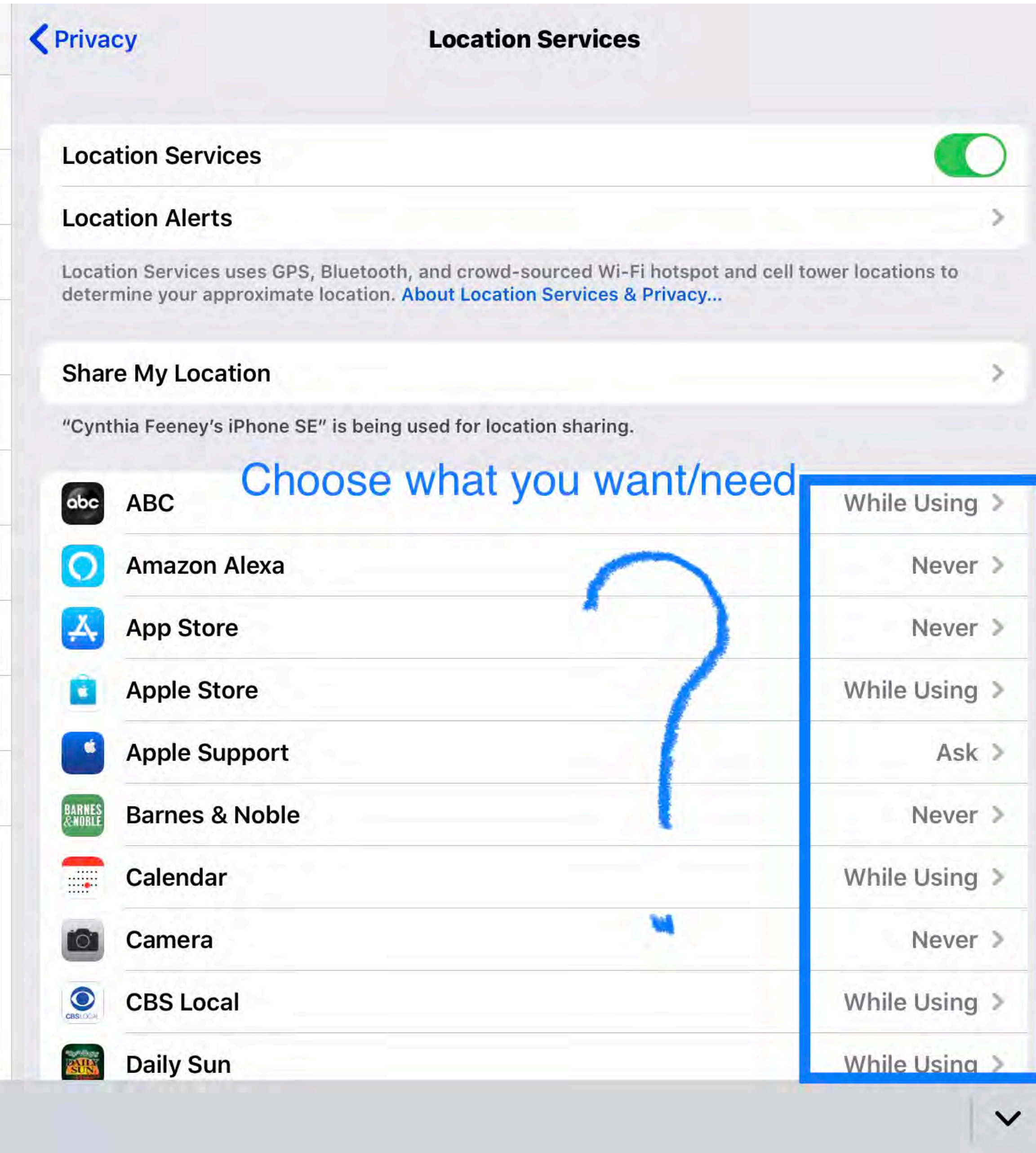
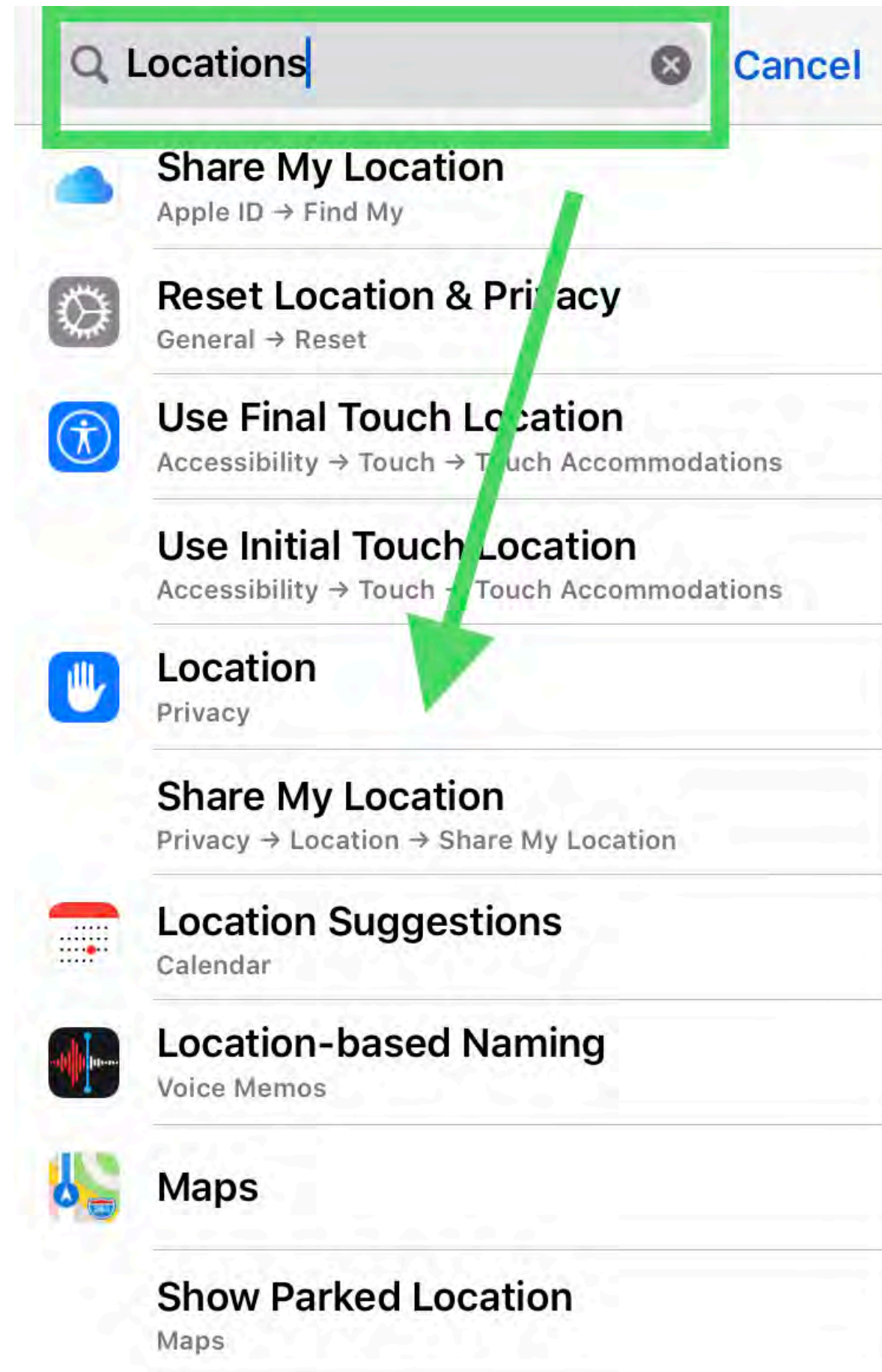

Wifi

**In An Emergency
To Conserve Battery
Turn off Wifi
Until Absolutely
Needed**

**This saved a kids life
when in danger and
lost**

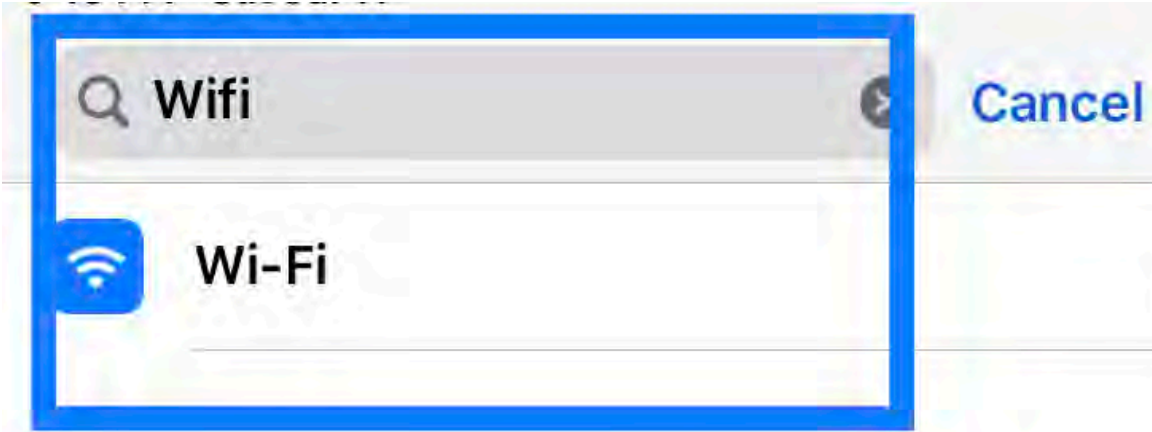

Do we always
want/need it on?

It is always looking
for the signal

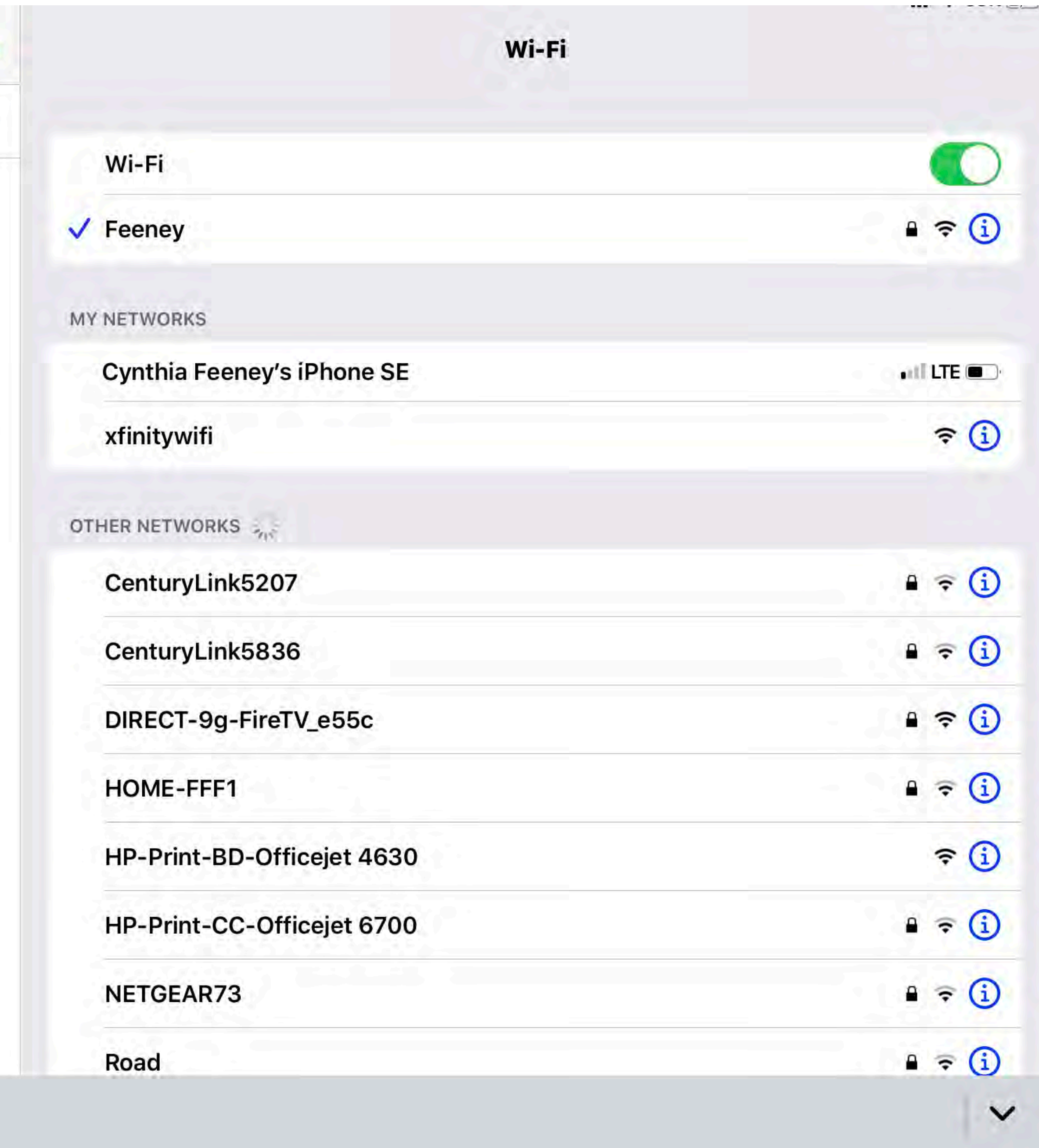

The background of the image is a stylized American flag with a dark blue canton containing white stars and red and white horizontal stripes. The flag has a slight wavy, draped appearance.

Thank you for Zooming Today